

8000 SERIES

PSM

MULTI-COUPLING



Multi-coupling (PSM)

PSM Multi couplers allow the simultaneous connection of two or even four hydraulic lines. The connection can be made with residual pressure.

It is designed to assemble each hydraulic valve with nuts, as shown in the picture. With just one move connects 4 or 2 valves at the same time.

Connection according to ISO 7241-A. It is possible to manually connect the sockets individually to connect auxiliary lines without the need for them to be installed on the mobile base.

System designed with threaded elements to do the maintenance of the assembly easily.

TECHNICAL SPECIFICATIONS

Material:	Steel
Seals:	NBR
Size:	1/2"
Connections:	2 / 4
Connection under pressure:	Allowed Residual

Working Temperature (O-ring)



Sectors: Vehicles / Agricultural / Industrial



8000-1

INTEVA reserves the right to make modifications to its products without prior notice. Any external or internal alterations to our products will automatically void the warranty.





8000 SERIES

PSM

MULTI-COUPLING

MODEL STRUCTURE

Example:

8000.11143 CO-H

Series	Material	Closing	Nº Connec	Size (S)	Thread	Part
8000	1 Carbon St.	1 Punzón 3 C.U.R.P.	2 Connec. 4 Connec.	3 13 1/2"	2 letters (see Table ofThreads page 999-1)	M Male H Female

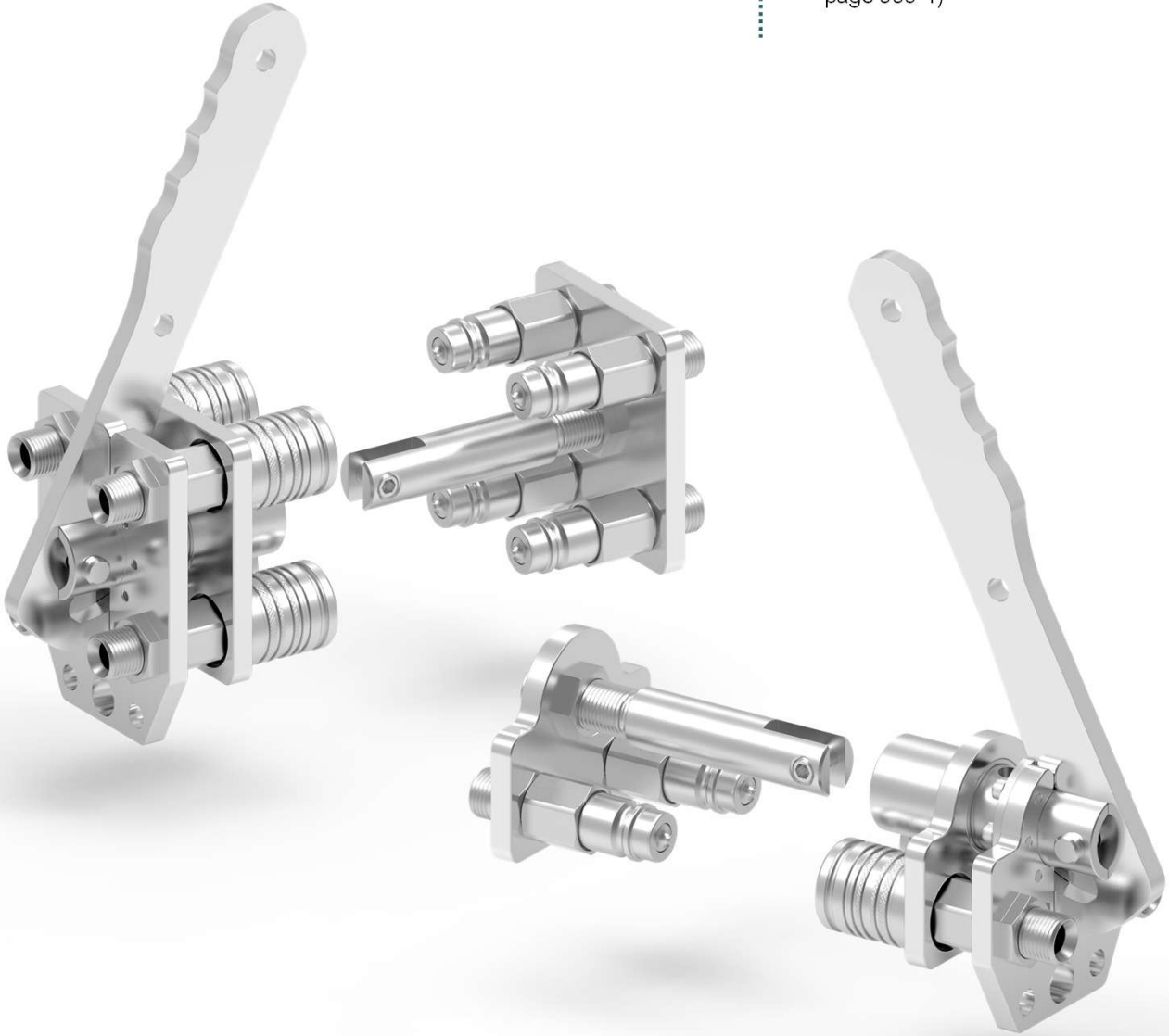

8000-2

INTEVA reserves the right to make modifications to its products without prior notice. Any external or internal alterations to our products will automatically void the warranty.



8000 SERIES PSM

MULTI-COUPLING

MODEL STRUCTURE / DIMENSIONS

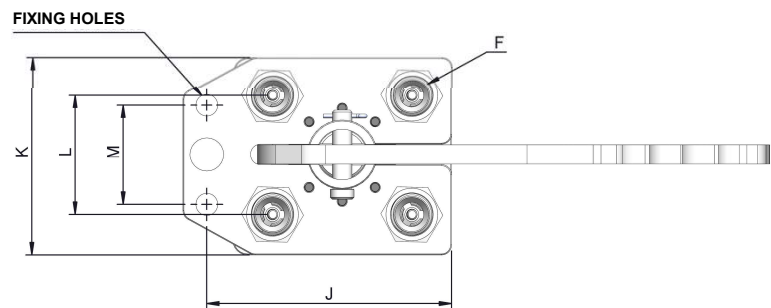
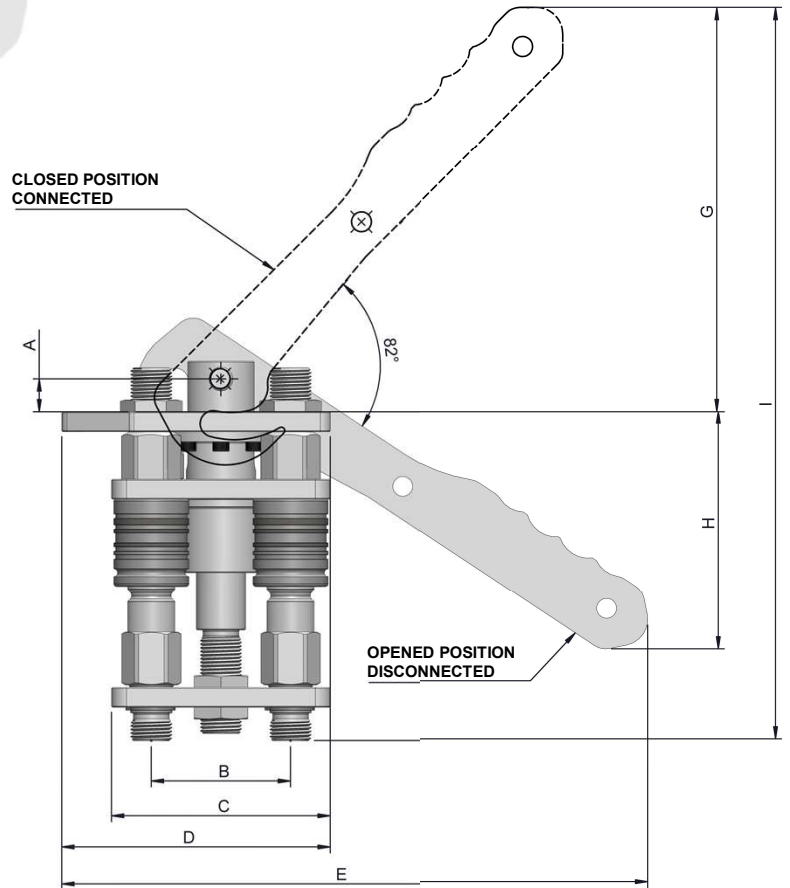

N° CONNEC.	F	REF.	A	B	C	D	E	G	H	I	J	K	L	M
4	1/2" BSP	8000.11143CO	16.5	70	110	135	295	203	121	370	123	100	60	50
	1/2" BSP	8000.11343CO												

8000-3

INTEVA reserves the right to make modifications to its products without prior notice. Any external or internal alterations to our products will automatically void the warranty.





8000 SERIES

PSM

MULTI-COUPLING

MODEL STRUCTURE

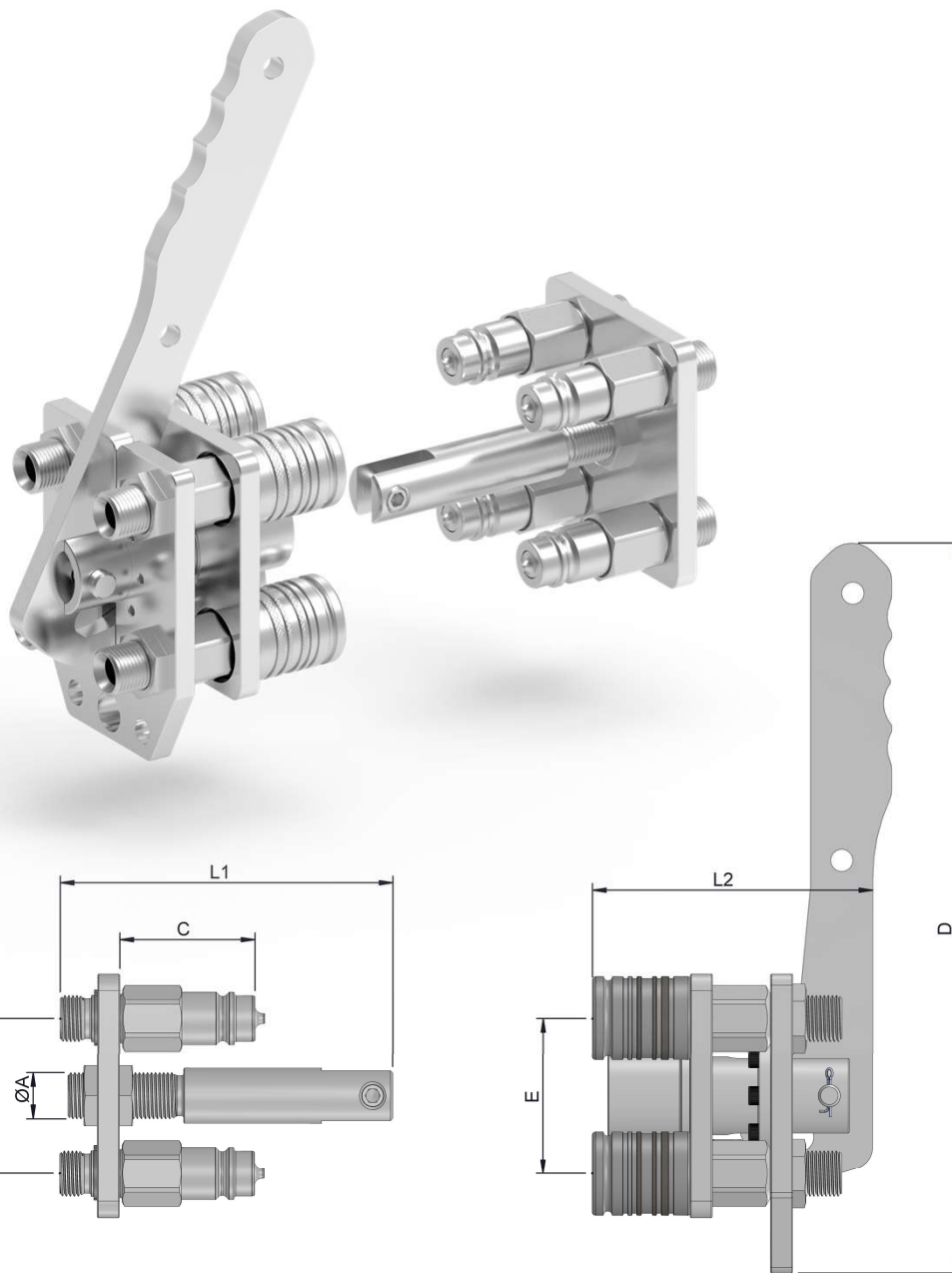

STANDARD MALE MODELS

(S)	ØA	REF.	B	C	L1
13	1/2" BSP	8000.11143CO-M	70	60.8	149.7
		8000.11343CO-M			

STANDARD FEMALE MODELS

(S)	ØA	REF.	D	E	L2
13	1/2" BSP	8000.11143CO-H	328.5	70	126
		8000.11343CO-H			

8000-4

INTEVA reserves the right to make modifications to its products without prior notice. Any external or internal alterations to our products will automatically void the warranty.





8000 SERIES

PSM

MULTI-COUPLING

MODEL STRUCTURE / DIMENSIONS

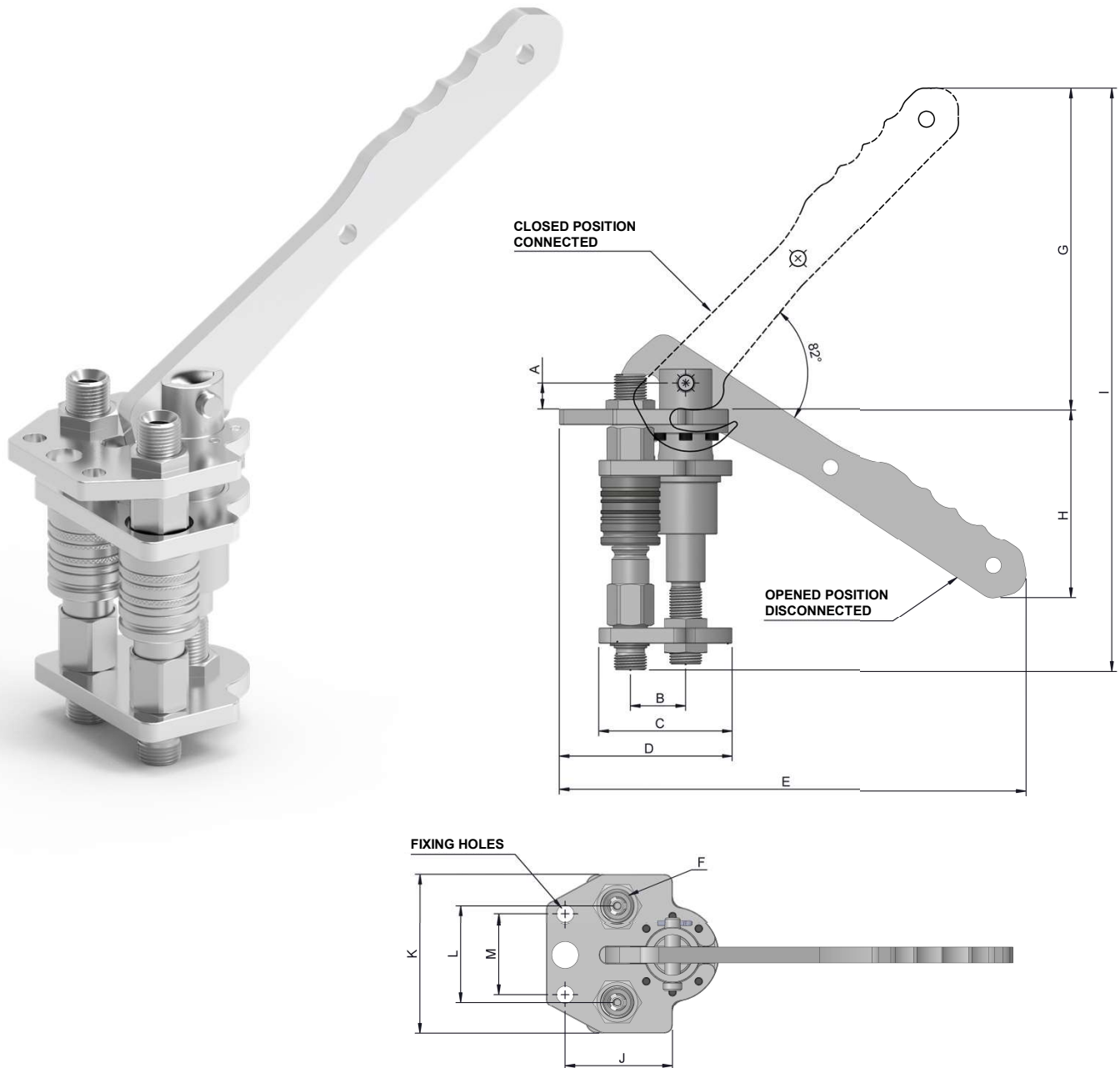

N° CONNEC.	F	REF.	A	B	C	D	E	G	H	I	J	K	L	M
2	1/2" BSP	8000.11123CO	16.5	35	84.5	109.5	295	203	132	370	68	100	60	50
	1/2" BSP	8000.11323CO												

8000-5

INTEVA reserves the right to make modifications to its products without prior notice. Any external or internal alterations to our products will automatically void the warranty.



v12



8000 SERIES

PSM

MULTI-COUPLING

MODEL STRUCTURE

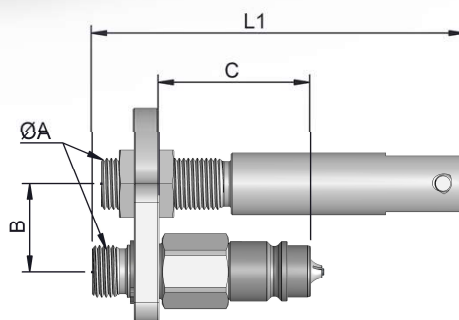
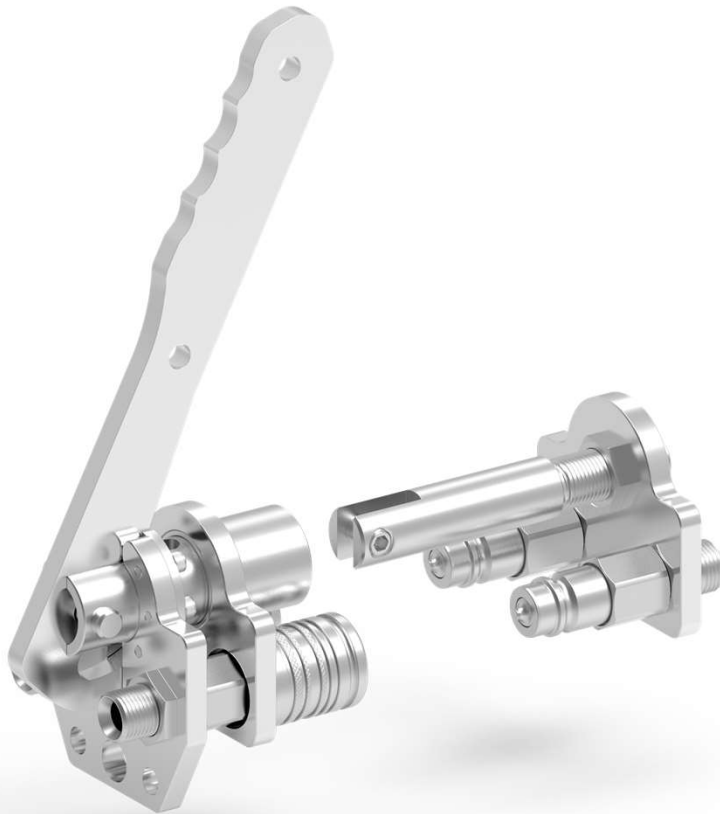

STANDARD MALE MODEL

(S)	ØA	REF.	B	C	L1
13	1/2" BSP	8000.11123CO-M	35	60.8	149.7
		8000.11323CO-M			

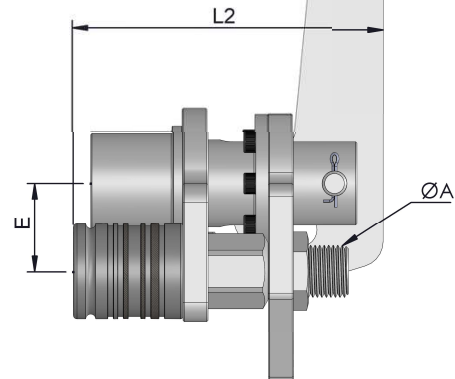
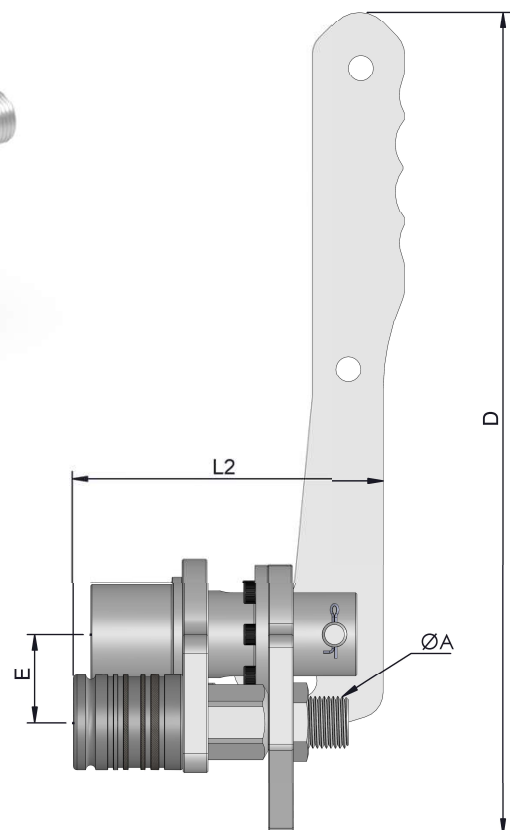

STANDARD FEMALE MODEL

(S)	ØA	REF.	D	E	L2
13	1/2" BSP	8000.11123CO-H	340	35	123.7
		8000.11323CO-H			

8000-6

INTEVA reserves the right to make modifications to its products without prior notice. Any external or internal alterations to our products will automatically void the warranty.





107 SERIES PSM

PUSH-PULL
MULTI-COUPLING

Manufactured according to ISO 7241-A.
(Size (S) 13 – 1/2" according to ISO 5675)

TECHNICAL SPECIFICATIONS

Operating pressure:	Up to 350 Bar	
Materials:	Body:	Carbon Steel EN-10277-3
	O-rings:	NBR / VITON / EPDM
	Back-up-ring:	PTFE
	Springs:	EN 10270-1/SH
	Balls:	AISI 1010/1015
Available Threads:	BSP	
Closing System:	C.U.R.P.	
Connection:	Multi-coupling	
Disconnection:	Multi-coupling	
Connection Under Pressure:	Allowed	

Available Size: 1/2"

Working Temperature (O-rings)

	NBR	Viton	EPDM
	+100°C -30°C	+200°C -10°C	+150°C -40°C

Sectors: Industrial / Agricultural



Applications: Designed for Hydraulic Oil (Group II-2014/68/EU)

Interchange:

MODEL STRUCTURE

Example:

107.12113 COVH

Series	Material	Part	Closing	O-rings	Size (S)	Threads
102. (Male)	1 Carbon S..	1 Male	0 Without	1 NBR	3 13	2 letters (see Table of Threads page 999-1)
107. (Female)		2 Female	1 Poppet	2 VITON	1/2"	
			2 Ball	3 EPDM		
			3 C.U.R.P.			

107-1

INTEVA reserves the right to make modifications to its products without prior notice. Any external or internal alterations to our products will automatically void the warranty.





107 SERIES PSM



PUSH-PULL
MULTI-COUPLING

Manufactured according to ISO 7241-A.
(Size (S) 13 – 1/2" according to ISO 5675)

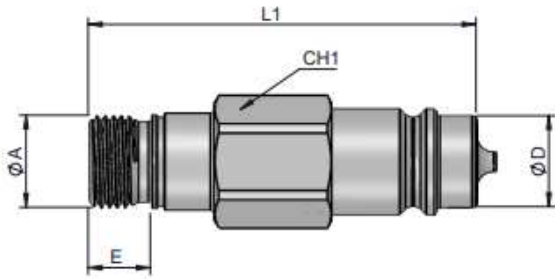
(S) 13 - 1/2"



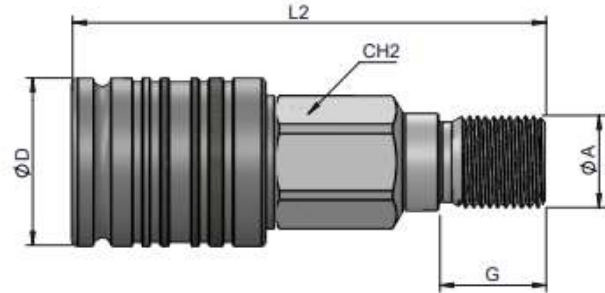

STANDARD MALE MODEL

(S)	ØA	REF.		CH1	L1	ØF	E
13	1/2" BSP	102.11113COVM		350	27	87.6	20.56
	1/2" BSP	102.11313COVM					



STANDARD FEMALE MODEL

(S)	ØA	REF.		CH2	L2	ØD	G
13	1/2" BSP	107.12113COVH		350	27	107	37.8
	1/2" BSP	107.12313COVH					

C.U.R.P. – Allows connection under Residual Pressure.

MULTI-COUPLING ASSEMBLE INSTRUCTIONS

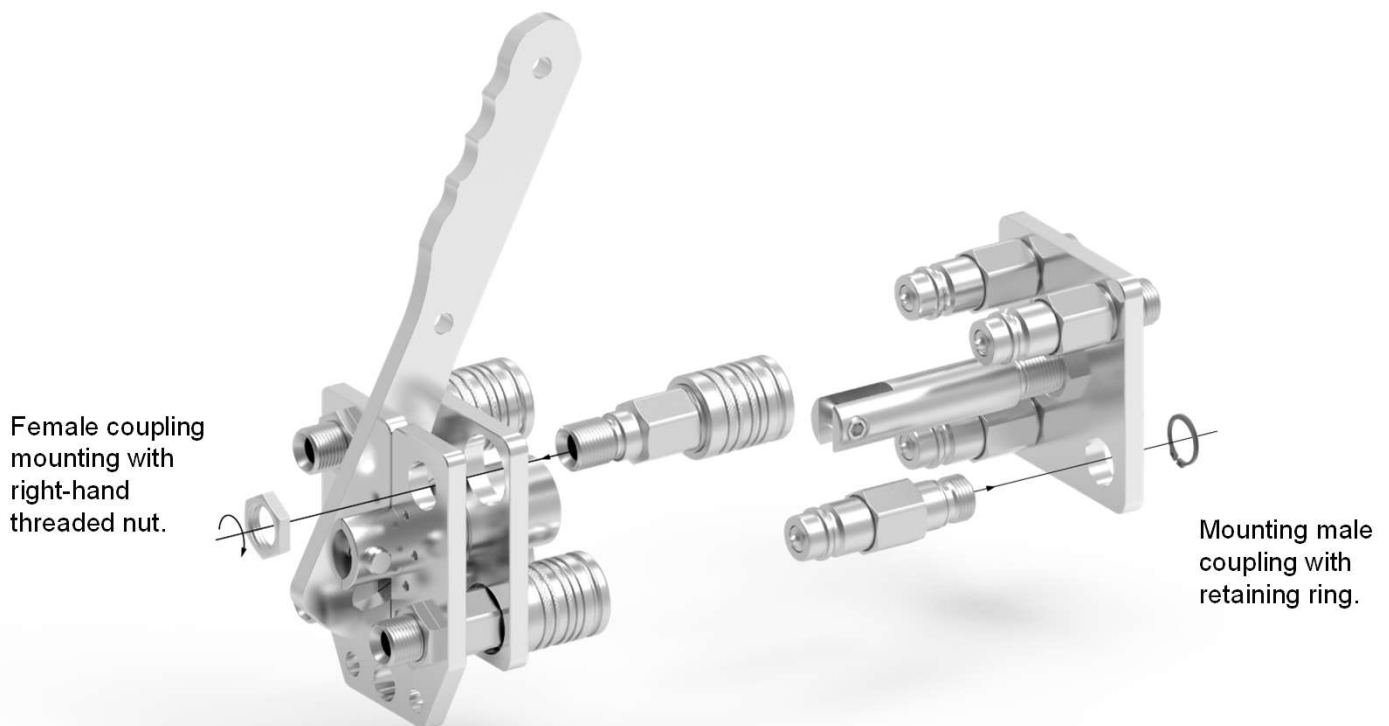

107-2

INTEVA reserves the right to make modifications to its products without prior notice. Any external or internal alterations to our products will automatically void the warranty.