

# SERIE 999 ROSCAS

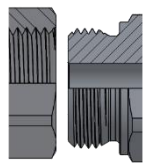

## ROSCAS MÉTRICAS ISO 261 – PUERTO / CONEXIÓN

### DIN 3852-1 B / ISO 9974



ROSCA	HEMBRA	MACHO
M8X1	NA	PA
M10X1	NB	PB
M12X1.5	NC	PC
M14X1.5	ND	PD
M16X1.5	NE	PE
M18X1.5	NF	PF
M20X1.5	NG	PG
M22X1.5	NH	PH
M24X1.5	NI	PI
M26X1.5	NO	PO
M27X2	-	-
M30X2	NJ	PJ
M33X2	NK	PK
M42X2	NL	PL
M48X2	NM	PM
M60X2	-	-

### ISO 6149-2 (ORB)

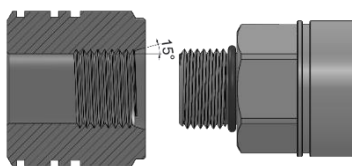

ROSCA	HEMBRA	MACHO
M8X1	EA	OA
M10X1	EC	OC
M12X1.5	EE	OE
M14X1.5	EF	OF
M16X1.5	EG	OG
M18X1.5	EH	OH
M20X1.5	EK	OK
M22X1.5	EM	OM
M24X1.5	-	-
M26X1.5	-	-
M27X2	-	-
M30X2	EJ	OJ
M33X2	EQ	OQ
M42X2	ET	OT
M48X2	EU	OU
M60X2	EV	OV

### ISO 9974-2 (E) / DIN 3852-11

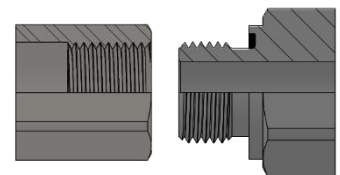

ROSCA	HEMBRA	MACHO
M8X1	NA	QA
M10X1	NB	QB
M12X1.5	NC	QC
M14X1.5	ND	QD
M16X1.5	NE	QE
M18X1.5	NF	QF
M20X1.5	NG	QG
M22X1.5	NH	QH
M24X1.5	-	-
M26X1.5	NO	QO
M27X2	-	-
M30X2	NJ	QJ
M33X2	NK	QK
M42X2	NL	QL
M48X2	NM	QM
M60X2	-	-

### ISO 8434-1 / DIN3861

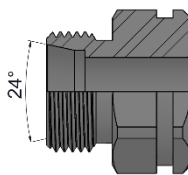

ROSCA	SERIE LIGERA		SERIE PESADA	
M12X1.5	6L	JB	-	-
M14X1.5	8L	JC	-	-
M16X1.5	10L	JD	8S	KD
M18X1.5	12L	JE	10S	KE
M20X1.5	-	-	12S	KF
M22X1.5	15L	JG	14S	KG
M24X1.5	-	-	16S	KH
M26X1.5	18L	JI	-	-
M30X2	22L	JJ	20S	KJ
M36X2	28L	JK	25S	KK
M42X2	-	-	30S	KL
M45X2	35L	JM	-	-
M52X2	42L	JN	38S	KN

### ISO 8434-1 / DIN3861

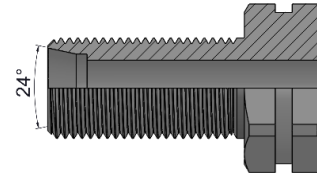

ROSCA	SERIE LIGERA		SERIE PESADA	
M12X1.5	6L	LB	-	-
M14X1.5	8L	LC	-	-
M16X1.5	10L	LD	8S	MD
M18X1.5	12L	LE	10S	ME
M20X1.5	-	-	12S	MF
M22X1.5	15L	LG	14S	MG
M24X1.5	-	-	16S	MH
M26X1.5	18L	LI	-	-
M30X2	22L	LJ	20S	MJ
M36X2	28L	LK	25S	MK
M42X2	-	-	30S	ML
M45X2	35L	LM	-	-
M52X2	-	-	38S	MN

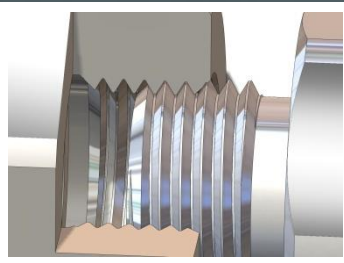

# SERIE 999 ROSCAS



## ROSCAS PASO UNIFICADO ASME B1.1 – PUERTO / CONEXIÓN

SAE 37° (JIC) /  
SAE J514 / ISO 8434-2

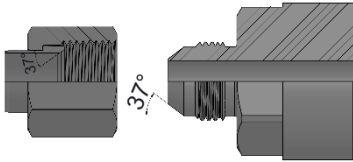

ROSCA	HEMBRA	MACHO
3/8"- 24h UNF	UA	YA
7/16"- 20h UNF	UB	YB
1/2"- 20h UNF	UC	YC
9/16"- 18h UNF	UD	YD
11/16"- 16h UN	UE	YE
3/4"- 16h UNF	UF	YF
13/16"- 16h UN	UG	YG
7/8"- 14h UNF	UH	YH
1" – 14 UNS	-	-
1 1/16"- 12h UN	UK	YK
1 3/16"- 12h UN	UM	YM
1 5/16"- 12h UN	UO	YO
1 7/16"- 12h UN	UQ	YQ
1 5/8"- 12h UN	UT	YT
1 11/16"- 12h UN	UU	YU
1 7/8"- 12h UN	UV	YV

SAE 37° (JIC) / SAE J514 / ISO 8434-2  
PASATABIQUE

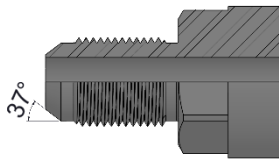

ROSCA	HEMBRA	MACHO
3/8"- 24h UNF	-	YAP
7/16"- 20h UNF	-	YBP
1/2"- 20h UNF	-	YCP
9/16"- 18h UNF	-	YDP
11/16"- 16h UN	-	YEP
3/4"- 16h UNF	-	YFP
13/16"- 16h UN	-	YGP
7/8"- 14h UNF	-	YHP
1" – 14 UNS	-	-
1 1/16"- 12h UN	-	YKP
1 3/16"- 12h UN	-	YMP
1 5/16"- 12h UN	-	YOP
1 7/16"- 12h UN	-	YQP
1 5/8"- 12h UN	-	YTP
1 11/16"- 12h UN	-	YUP
1 7/8"- 12h UN	-	YVP

SAE J1926 / ISO 11926  
(ORB)

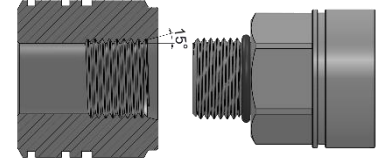

ROSCA	HEMBRA SAE J1926-1	MACHO SAE J1926-2
3/8"- 24h UNF	GA	HA
7/16"- 20h UNF	GB	HB
1/2"- 20h UNF	GC	HC
9/16"- 18h UNF	GD	HD
11/16"- 16h UN	GE	HE
3/4"- 16h UNF	GF	HF
13/16"- 16h UN	GG	HG
7/8"- 14h UNF	GH	HH
1" – 14 UNS	-	-
1 1/16"- 12h UN	GK	HK
1 3/16"- 12h UN	GM	HM
1 5/16"- 12h UN	GO	HO
1 7/16"- 12h UN	GQ	HQ
1 5/8"- 12h UN	GT	HT
1 11/16"- 12h UN	GU	HU
1 7/8"- 12h UN	GV	HV

SAE J1453 / ISO 8434-3  
(ORFS)

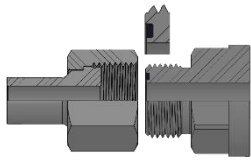

ROSCA	HEMBRA	MACHO
3/8"- 24h UNF	-	-
7/16"- 20h UNF	-	-
1/2"- 20h UNF	-	-
9/16"- 18h UNF	VD	ZD
11/16"- 16h UN	VE	ZE
3/4"- 16h UNF	-	-
13/16"- 16h UN	VG	ZG
7/8"- 14h UNF	-	-
1" – 14 UNS	VI	ZI
1 1/16"- 12h UN	-	-
1 3/16"- 12h UN	VM	ZM
1 5/16"- 12h UN	VO	ZO
1 7/16"- 12h UN	VQ	ZQ
1 5/8"- 12h UN	-	-
1 11/16"- 12h UN	VU	ZU
1 7/8"- 12h UN	-	-

SAE J1453 / ISO 8434-3  
(ORFS Pasatabique)

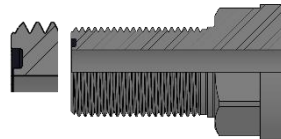

ROSCA	HEMBRA	MACHO
3/8"- 24h UNF	-	ZAP
7/16"- 20h UNF	-	ZBP
1/2"- 20h UNF	-	ZCP
9/16"- 18h UNF	-	ZDP
11/16"- 16h UN	-	ZEP
3/4"- 16h UNF	-	ZFP
13/16"- 16h UN	-	ZGP
7/8"- 14h UNF	-	ZHP
1" – 14 UNS	-	ZIP
1 1/16"- 12h UN	-	ZKP
1 3/16"- 12h UN	-	ZMP
1 5/16"- 12h UN	-	ZOP
1 7/16"- 12h UN	-	ZQP
1 5/8"- 12h UN	-	ZTP
1 11/16"- 12h UN	-	ZUP
1 7/8"- 12h UN	-	ZVP

## ESPECIALES

ROSCA	HEMBRA	MACHO
3/8"- 24h UNF	VA	ZA
7/16"- 20h UNF	VB	ZB
1/2"- 20h UNF	VC	ZC
3/4"- 16h UNF	VF	ZF
7/8"- 14h UNF	VH	ZH
1 1/16"- 12h UN	VK	ZK
1 5/8"- 12h UN	VT	ZT
1 7/8"- 12h UN	VV	ZV

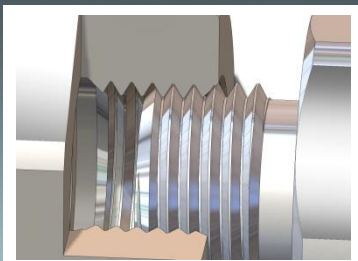

# SERIE 999 ROSCAS



## ROSCAS CÓNICAS

**NPTF**  
ASME B1.20.3

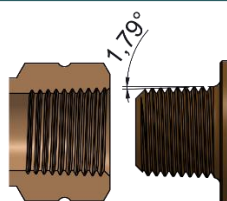

ROSCA	HEMBRA	MACHO
1/8"	BA	BL
1/4"	BB	BM
3/8"	BC	BN
1/2"	BD	BO
3/4"	BE	BP
1"	BF	BQ
1 1/4"	BG	BR
1 1/2"	BH	BS
2"	BI	BT
2 1/2"	BJ	BU
3"	BK	BV

**BSPT**  
ISO 7/1 (DIN 3852-2 C)

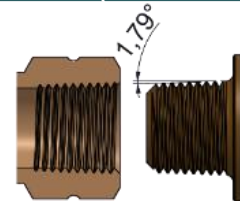

ROSCA	HEMBRA	MACHO
1/8"	DA	DL
1/4"	DB	DM
3/8"	DC	DN
1/2"	DD	DO
3/4"	DE	DP
1"	DF	DQ
1 1/4"	DG	DR
1 1/2"	DH	DS
2"	DI	DT
2 1/2"	-	-
3"	-	-

## ROSCAS BSP ISO 228/1

**BSPP / BS5200**

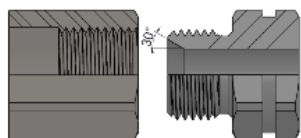

ROSCA	HEMBRA	MACHO
1/8"	AA	AL
1/4"	AB	AM
3/8"	AC	AN
1/2"	AD	AO
3/4"	AE	AP
1"	AF	AQ
1 1/4"	AG	AR
1 1/2"	AH	AS
2"	AI	AT
2 1/2"	AJ	AU
3"	AK	AV

**BSPP / BS5200**  
PASATABIQUE

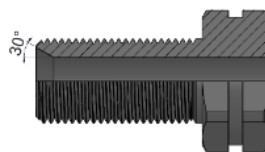

ROSCA	HEMBRA	MACHO
1/8"	-	CL
1/4"	-	CM
3/8"	-	CN
1/2"	-	CO
3/4"	-	CP
1"	-	CQ
1 1/4"	-	CR
1 1/2"	-	CS
2"	-	CT
2 1/2"	-	-
3"	-	-

## ESPECIALES

ROSCA	
M20X1.5 (13.5)	KFA
M20X1.5 (CONO 60°)	KFB
M16X1.5 PASATABIQUE M20X1.5	JDA
M22X1.5 PROLOGADA	JGA
M22X1.5 15L LONG. HEX 35MM	JGB
M22X1.5 PASATABIQUE PROLOGADA	LGA
3/4" 16h UNF (SIN CONO 37°)	HFA
3/4" 16h UNF (CILINDRICA)	GFA