



504 SERIES ATR

ANTI-RETURN VALVES



TECHNICAL SPECIFICATIONS

Features:	Designed to avoid the return of the fluid inside the circuit.	
	Metal Closure (without O-ring): Steel construction without seals or other components to wear out.	
	High resistance to pressure peaks.	
	5 psi standard opening pressure. Other opening pressures on request.	
Available Size:	1/8" a 2"	
Operating pressure:	Up to 300 Bar	
Materials:	Body:	Carbon Steel EN 10277-3 AISI 316
	O-rings:	NBR / VITON / EPDM
	Springs:	EN 10270-3/-1/SH
Available Threads:	BSP / NPTF*	
Closing System:	Poppet (without o-ring) / Available with O-rings	
Applications:	Designed for oil hydraulic (Group II- 2014/68/EU)	
Interchangeable:	GROMELLE 4000 / DMIC CVH	
	PARKER DC / SNAP TITE CPIFF	

Working Temperature (O-rings)

	NBR	Viton	EPDM
+	+100°C	+200°C	+150°C
-	-30°C	-10°C	-40°C

Sectors:

Carbon Steel → Industrial

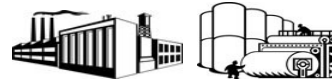

Stainless Steel → Industrial / Chemical / Offshore



* On request and minimum quantity..

MODEL STRUCTURE

Example:

504.110006 AG

Series	Materials	Closing	O-ring	Opening pressure ± 0,3	Size (S)	Thread
504.	1 Carbon St. 2 AISI 316	1 Poppet	0 Without	00 0.34 Bar / 5 psi	0 4	2 letters as per Table of Threads
			1 NBR (90Sh)	10 1 Bar / 14psi	1 6	
	2 VITON		25 2.5 Bar / 36 psi	2 10		
	3 EPDM		45 4.5 Bar / 65 psi	3 13		
			60 6 Bar / 87 psi	4 20		
			80 8 Bar / 115 psi	5 25		
			99 10 Bar / 145 psi	6 32		
				7 40		
				8 50		
				1 1/2"		
				2 "		



504 SERIES ATR

ANTI-RETURN VALVES
CARBON STEEL



(S) 04 - 1/8"

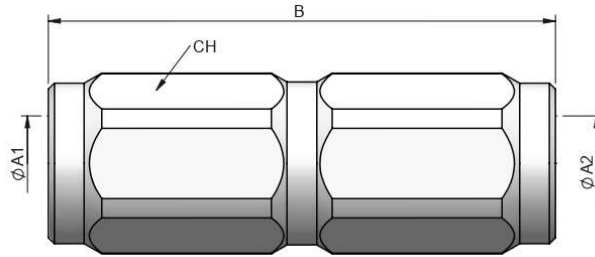

STANDARD MODELS

(S)	ØA1/ØA2	REF.		CH	B
04	1/8" BSP	504.110000AA	300	14	42.5
	1/8" NPTF	504.110000BA			

(S) 06 - 1/4"

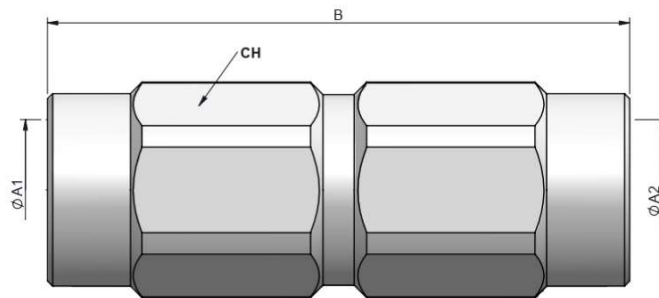

STANDARD MODELS

(S)	ØA1/ØA2	REF.		CH	B
6	1/4" BSP	504.110001AB	300	19	56
	1/4" NPTF	504.110001BB			

504-2

INTEVA reserves the right to make modifications to its products without prior notice. Any external or internal alterations to our products will automatically void the warranty.





504 SERIES ATR

ANTI-RETURN VALVES
CARBON STEEL



(S) 10 - 3/8"

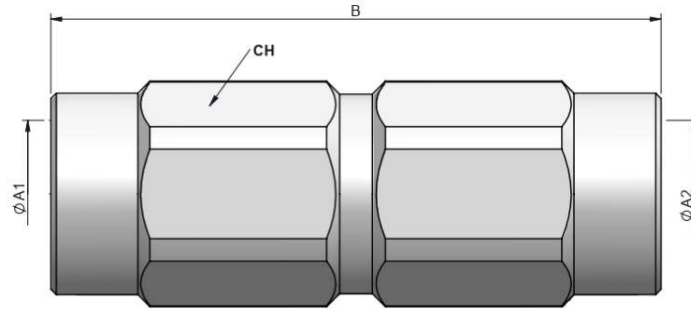

STANDARD MODELS

(S)	ØA1/ØA2	REF.		CH	B
10	3/8" BSP	504.110002AC	300	22	67.5
	3/8" NPTF	504.110002BC			

(S) 13 - 1/2"

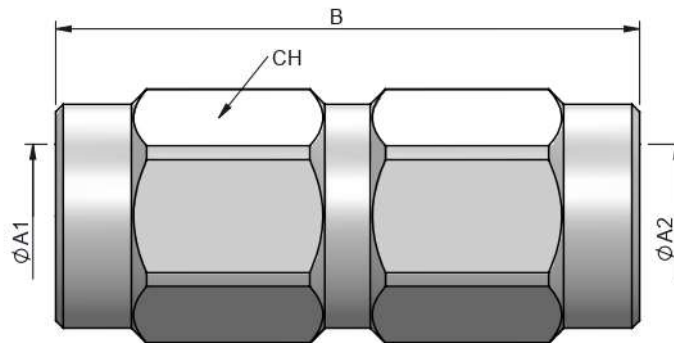

STANDARD MODELS

(S)	ØA1/ØA2	REF.		CH	B
13	1/2" BSP	504.110003AD	300	30	77
	1/2" NPTF	504.110003BD			

504-3

INTEVA reserves the right to make modifications to its products without prior notice. Any external or internal alterations to our products will automatically void the warranty.





504 SERIES ATR

ANTI-RETURN VALVES
CARBON STEEL



(S) 20 - 3/4"

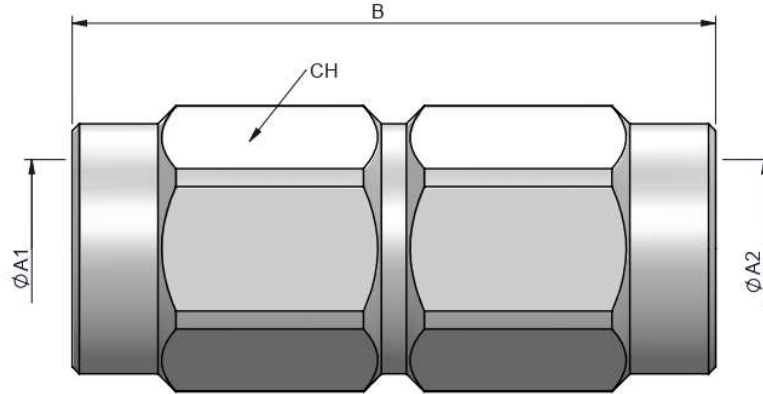

STANDARD MODELS

(S)	ØA1/ØA2	REF.		CH	B
20	3/4" BSP	504.110004AE	300	36	90
	3/4" NPTF	504.110004BE			

(S) 25 - 1"

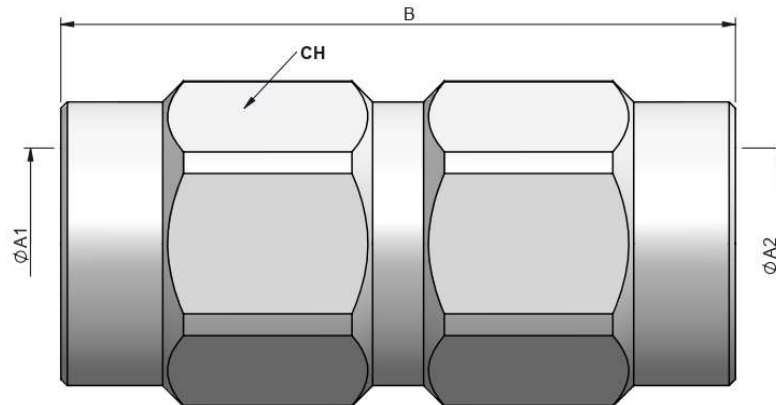

STANDARD MODELS

(S)	ØA1/ØA2	REF.		CH	B
25	1" BSP	504.110005AF	300	46	106
	1" NPTF	504.110005BF			

504-4

INTEVA reserves the right to make modifications to its products without prior notice. Any external or internal alterations to our products will automatically void the warranty.





504 SERIES ATR

ANTI-RETURN VALVES
CARBON STEEL



(S) 32 – 1 1/4”

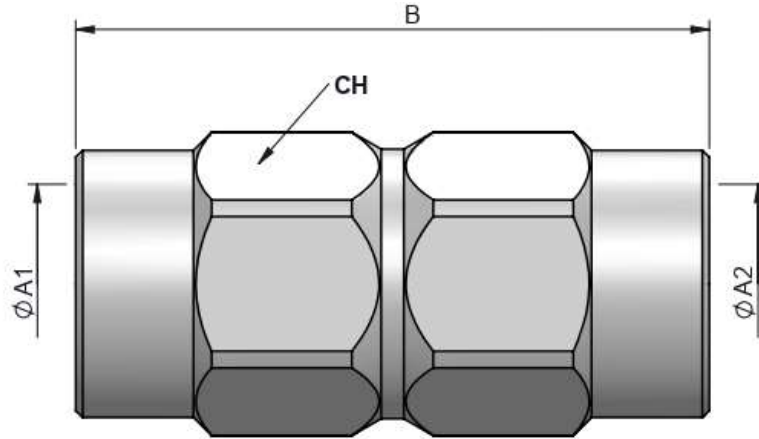

STANDARD MODELS

(S)	ØA1/ØA2	REF.		CH	B
32	1 1/4” BSP	504.110006AG	300	55	125
	1 1/4” NPTF	504.110006BG			

(S) 40 – 1 1/2”

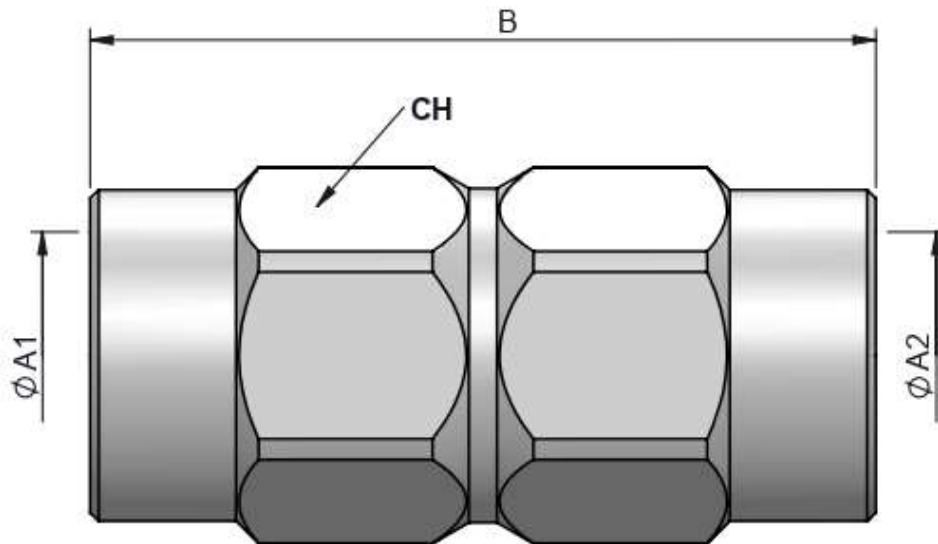

STANDARD MODELS

(S)	ØA1/ØA2	REF.		CH	B
40	1 1/2” BSP	504.110007AH	300	60	140
	1 1/2” NPTF	504.110007BH			

504-5

INTEVA reserves the right to make modifications to its products without prior notice. Any external or internal alterations to our products will automatically void the warranty.





504 SERIES ATR

ANTI-RETURN VALVES
CARBON STEEL



(S) 50 – 2"

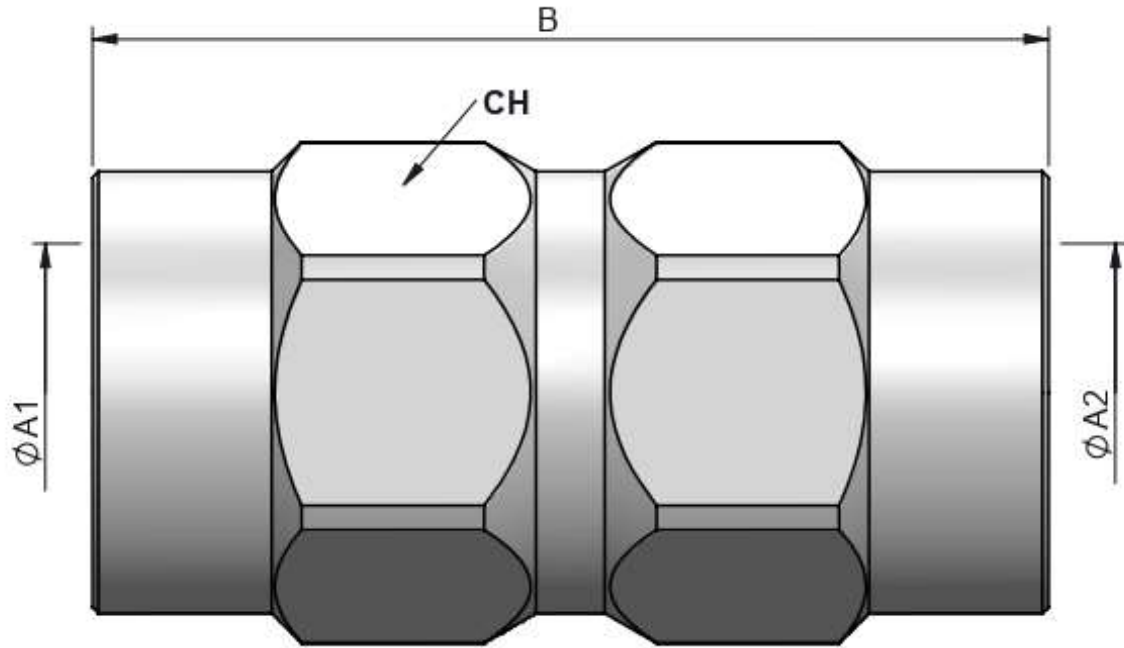

STANDARD MODELS

(S)	$\phi A1/\phi A2$	REF.		CH	B
50	2" BSP	504.110008AI	200	75	160
	2" NPTF	504.110008BI			

504-6

INTEVA reserves the right to make modifications to its products without prior notice. Any external or internal alterations to our products will automatically void the warranty.





504 SERIES ATR

ANTI-RETURN VALVES
AISI 316



(S) 04 - 1/8"

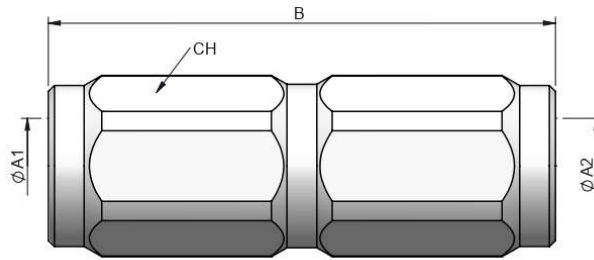

STANDARD MODELS

(S)	ØA1/ØA2	REF.		CH	B
04	1/8" BSP	504.210000AA	300	14	42.5
	1/8" NPTF	504.210000BA			

(S) 06 - 1/4"

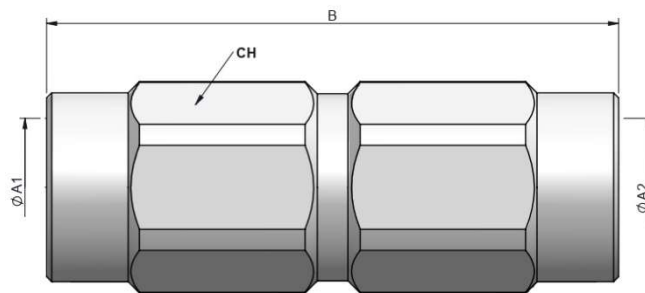

STANDARD MODELS

(S)	ØA1/ØA2	REF.		CH	B
6	1/4" BSP	504.210001AB	300	19	56
	1/4" NPTF	504.210001BB			

504-2

INTEVA reserves the right to make modifications to its products without prior notice. Any external or internal alterations to our products will automatically void the warranty.





504 SERIES ATR

ANTI-RETURN VALVES
AISI 316



(S) 10 - 3/8"

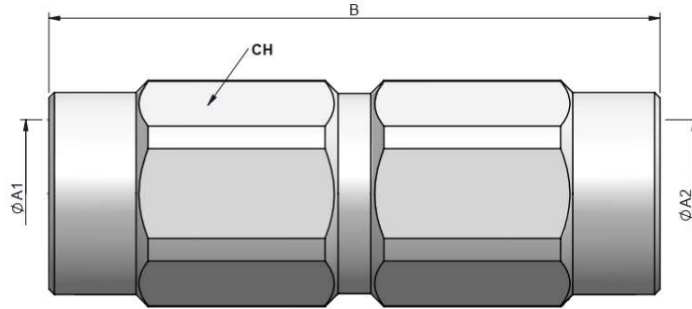

STANDARD MODELS

(S)	ØA1/ØA2	REF.		CH	B
10	3/8" BSP	504.210002AC	300	22	67.5
	3/8" NPTF	504.210002BC			

(S) 13 - 1/2"

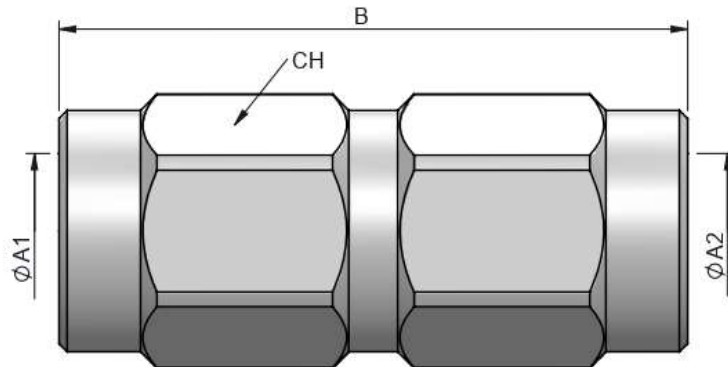

STANDARD MODELS

(S)	ØA1/ØA2	REF.		CH	B
13	1/2" BSP	504.210003AD	300	30	77
	1/2" NPTF	504.210003BD			

504-3

INTEVA reserves the right to make modifications to its products without prior notice. Any external or internal alterations to our products will automatically void the warranty.







504 SERIES ATR

ANTI-RETURN VALVES
AISI 316

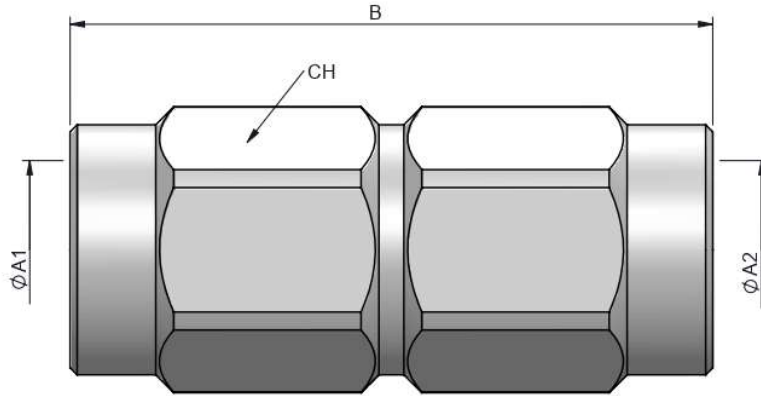
(S) 20 - 3/4"



STANDARD MODELS

(S)	ØA1/ØA2	REF.		CH	B
20	3/4" BSP	504.210004AE	300	36	90
	3/4" NPTF	504.210004BE			

(S) 25 - 1"

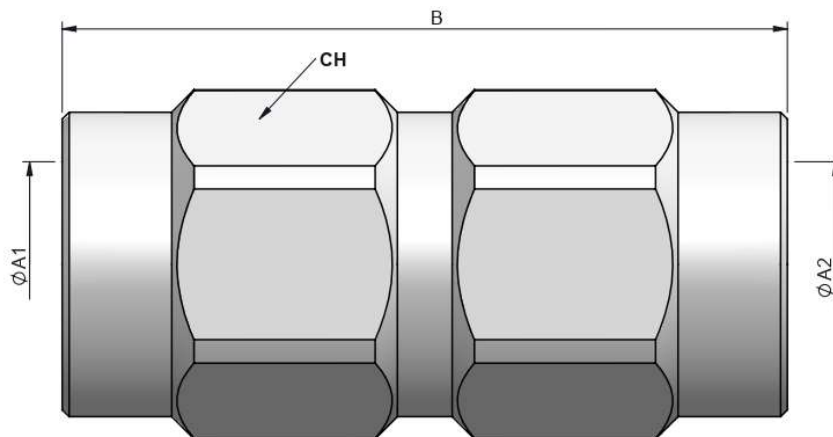

STANDARD MODELS

(S)	ØA1/ØA2	REF.		CH	B
25	1" BSP	504.210005AF	300	46	106
	1" NPTF	504.210005BF			

504-4

INTEVA reserves the right to make modifications to its products without prior notice. Any external or internal alterations to our products will automatically void the warranty.





504 SERIES ATR

ANTI-RETURN VALVES
AISI 316



(S) 32 – 1 1/4"

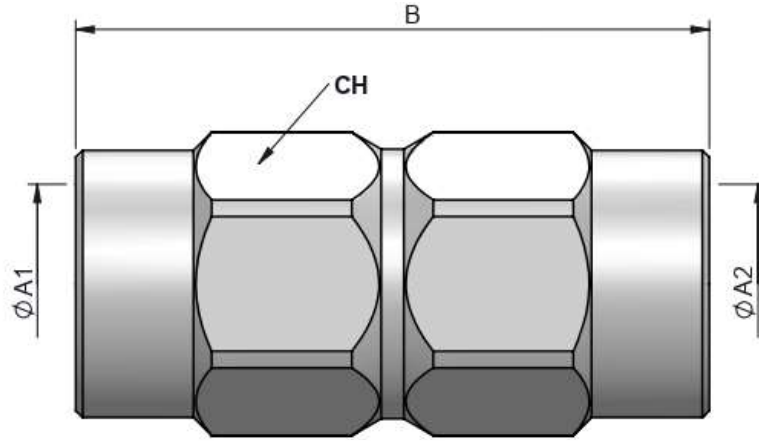

STANDARD MODELS

(S)	ØA1/ØA2	REF.		CH	B
32	1 1/4" BSP	504.210006AG	300	55	125
	1 1/4" NPTF	504.210006BG			

(S) 40 – 1 1/2"

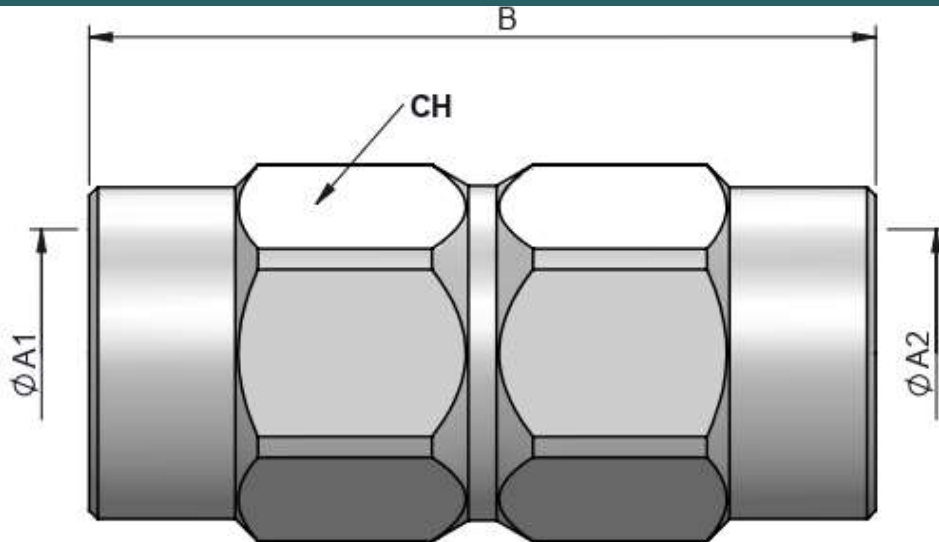

STANDARD MODELS

(S)	ØA1/ØA2	REF.		CH	B
40	1 1/2" BSP	504.210007AH	300	60	140
	1 1/2" NPTF	504.210007BH			

504-5

INTEVA reserves the right to make modifications to its products without prior notice. Any external or internal alterations to our products will automatically void the warranty.







504 SERIES ATR

ANTI-RETURN VALVES
AISI 316

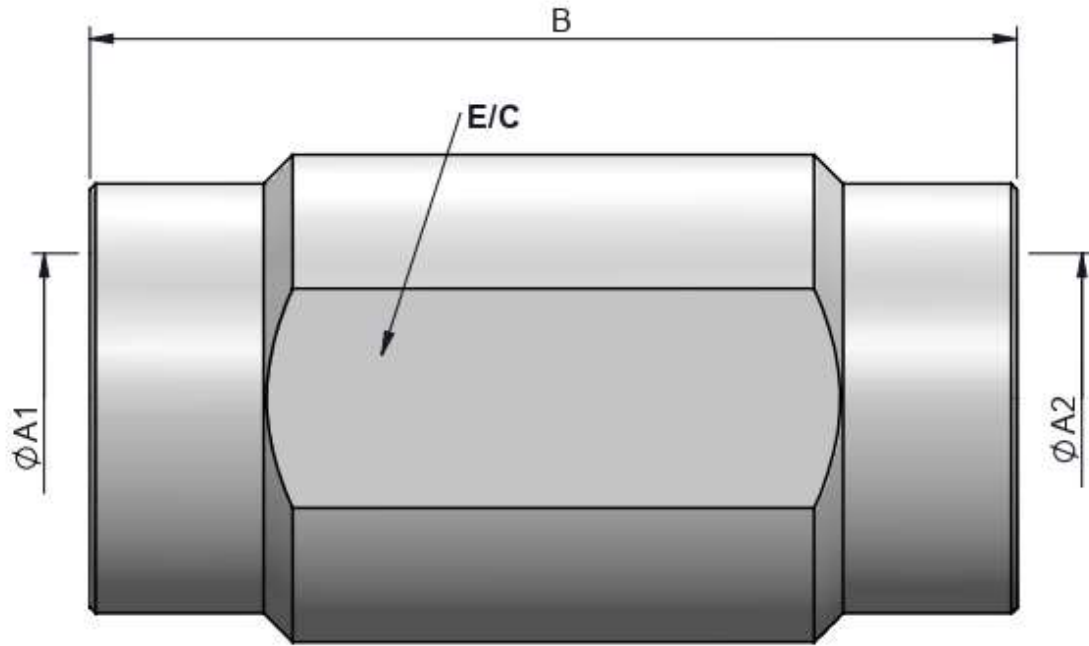
(S) 50 – 2"



STANDARD MODELS

(S)	$\phi A1/\phi A2$	REF.		E/C	B
50	2" BSP	504.210008AI	200	75	160
	2" NPTF	504.210008BI			

504-6

INTEVA reserves the right to make modifications to its products without prior notice. Any external or internal alterations to our products will automatically void the warranty.





504 SERIES ATR

CARBON STEEL
AISI 316



TECHNICAL DATA

(S)	Max. Rated Flow	Max. Working Pressure	Min. Burst Pressure
	l/m / GPM	Bar / psi	Bar / psi
04	8 / 2.11	300 / 4350	1200 / 17400
06	26 / 6.87	300 / 4350	1200 / 17400
10	44 / 11.6	300 / 4350	1200 / 17400
13	90 / 23.85	300 / 4350	1200 / 17400
20	152 / 40.2	300 / 4350	1200 / 17400
25	200 / 52.8	300 / 4350	1200 / 17400
32	370 / 97.8	300 / 4350	1200 / 17400
40	598 / 158	300 / 4350	1200 / 17400
50	875 / 231	200 / 2900	800 / 11600

Test performed according to ISO 18869

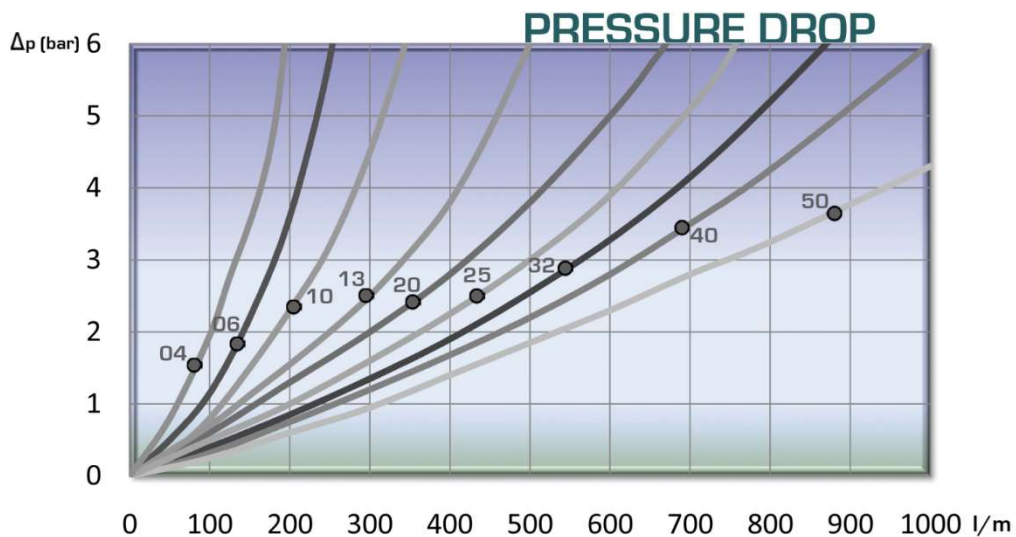

504-12

INTEVA reserves the right to make modifications to its products without prior notice. Any external or internal alterations to our products will automatically void the warranty.

