



# 131 SERIES CPR

FEMALE FOR UNDERGROUND  
GARBAGE ELEVATORS

Manufactured according to ISO 16028.

## TECHNICAL SPECIFICATIONS

Developed for hammer applications and systems with frequent high pulsating pressure.

**Features:**

Nickel plated outer body for a higher corrosion resistance to ensure durability under the most extreme conditions.  
Ergonomically shape for easy connection and disconnection.

Compact flat face that eliminates leaks and contamination of the circuit.

<b>Operating pressure:</b>	Up to 350 Bar	
<b>Materials:</b>	Body:	Carbon Steel EN 10277-3
	O-rings:	NBR / VITON / EPDM
	Back-up-ring:	PTFE
	Springs:	EN 10270-1/SH
	Balls:	AISI 1010/1015
<b>Available Threads:</b>	BSP	
<b>Closing System:</b>	Flat Face	
<b>Connection / Disconnection:</b>	Press to connect / Sleeve Retraction	
<b>Connection Under Pressure:</b>	Not Allowed	

**Available Size:** 3/8"

**Working Temperature (O-rings)**

	NBR	Viton	EPDM
+	+100°C	+200°C	+150°C
-	-30°C	-10°C	-40°C

**Sectors:** Underground garbage elevators

**Applications:** Designed for Hydraulic Oil (Group II-2014/68/EU)

**Interchange:** -

(S) 10 - 3/8"

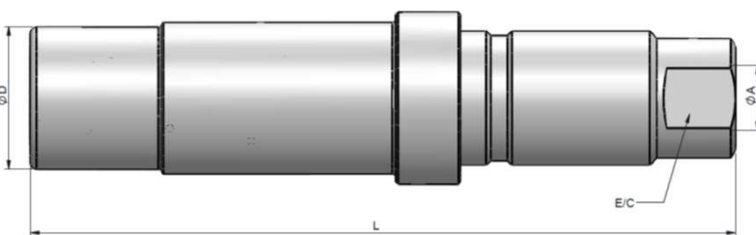

**STANDARD FEMALE MODELS**

(S)	ØA	REF.		E/C	ØD	L
10	3/8" BSP	131SB.12112AC	350	24	33	164

## TECHNICAL DATA

Rated Flow l/m	Min Burst Pressure (Bar)			Max. Working Pressure
	Male	Female	Conect.	Bar
45 l/m	1300	1200	1400	350

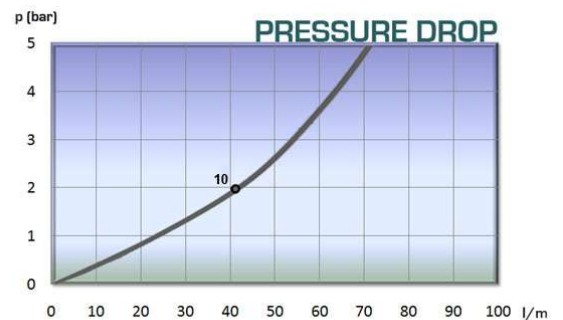

131-27

INTEVA reserves the right to make modifications to its products without prior notice. Any external or internal alterations to our products will automatically void the warranty.

