



131 SERIES CPR

FEMALE FOR UNDERGROUND
GARBAGE ELEVATORS

Manufactured according to ISO 16028.

TECHNICAL SPECIFICATIONS

Features:

- Developed for hammer applications and systems with high frequency pulsating pressure..
- Nickel plated outer body chemical very corrosion resistant to ensure durability under the most extreme.
- Ergonomically shaped for easy connection and disconnection.
- Compact flat face that eliminates leaks and contamination of the circuit.

Operating pressure:	Up to 350 Bar	
Materials:	Body:	Carbon Steel EN 10277-3
	O-rings:	NBR / VITON / EPDM
	Back-up-ring:	PTFE
	Springs:	EN 10270-1/SH
	Balls:	AISI 1010/1015
Available Threads:	BSP	
Closing System:	Flat Face	
Connection / Disconnection:	Press to connect / Sleeve Retraction	
Connection Under Pressure:	Not Allowed	

Available Size: 3/8"

Working Temperature (O-rings)

	NBR	Viton	EPDM
+	+100°C	+200°C	+150°C
-	-30°C	-10°C	-40°C

Sectors: Underground garbage elevators

Applications: Designed for Hydraulic Oil (Group II-2014/68/EU)

Interchange: -

(S) 10 - 3/8"

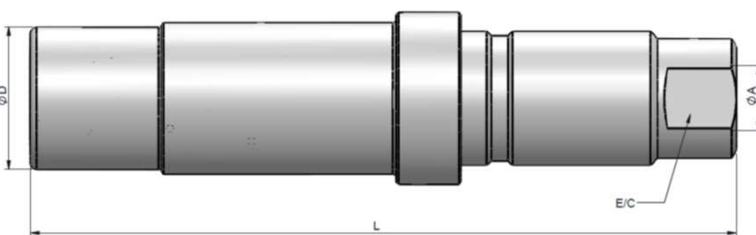

STANDARD FEMALE MODELS

(S)	ØA	REF.		E/C	ØD	L
10	3/8" BSP	131SB.12112AC	350	24	33	164

TECHNICAL DATA

Rated Flow l/m	Min Burst Pressure (Bar)			Max. Working Pressure Bar
	Male	Female	Conect.	
45 l/m	1300	1200	1400	350

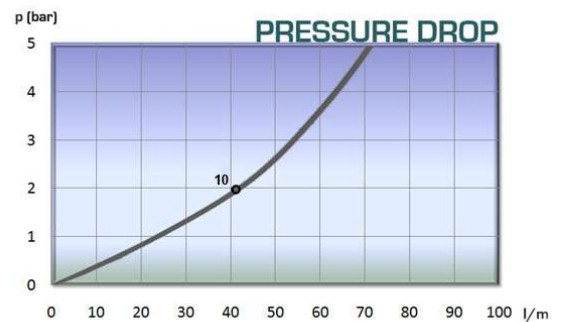

131-27

INTEVA reserves the right to make modifications to its products without prior notice. Any external or internal alterations to our products will automatically void the warranty.

